



Mounting brackets for Ex apparatus



Jola Spezienschalter GmbH & Co. KG
Klostergartenstr. 11 • 67466 Lambrecht (Germany)
Tel. +49 6325 188-01 • Fax +49 6325 6396
contact@jola-info.de • www.jola-info.de



Mounting bracket

made of stainless steel 316 Ti

with lateral oblong hole

- **MW 100x100x60/G $\frac{1}{2}$ /L/Ex**
for G $\frac{1}{2}$ stuffing gland or
screw-in nipple
(fixing of the stuffing gland
or screw-in nipple via G $\frac{1}{2}$
counter nut)

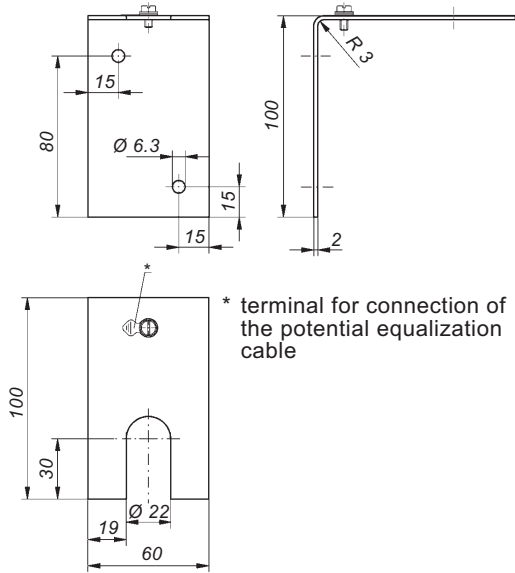

- **MW 100x100x60/G1/L/Ex**
for G1 stuffing gland or
screw-in nipple
(fixing of the stuffing gland
or screw-in nipple via G1
counter nut)

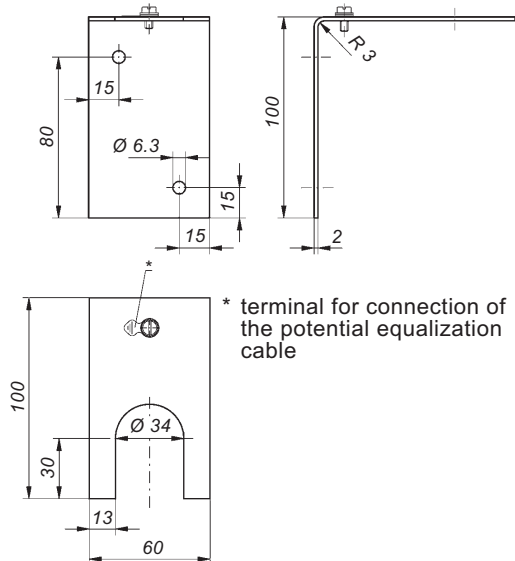



Mounting bracket

made of stainless steel 316 Ti
with lateral oblong hole

- **MW 100x100x90/G2/L/Ex**
for G2 stuffing gland or
screw-in nipple
(fixing of the stuffing gland
or screw-in nipple via G2
counternut)

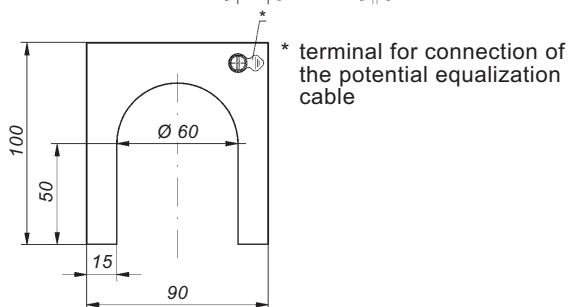
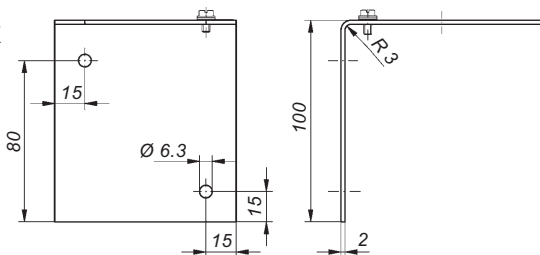

- **MW 100x150x60/G1/L/Ex**
for G1 stuffing
gland or
screw-in nipple
(fixing of the
stuffing gland or
screw-in nipple via
G1 counter nut)

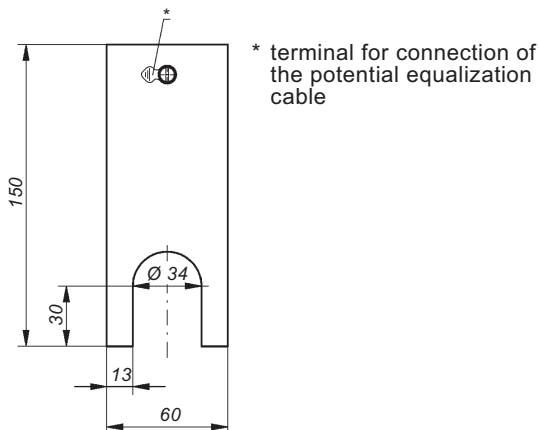
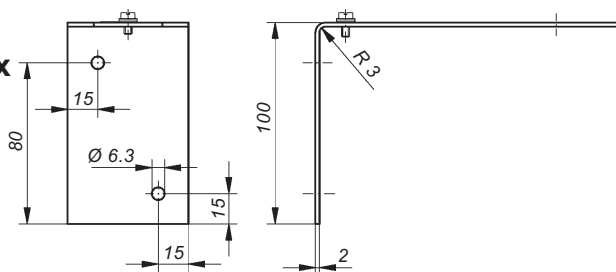



Mounting bracket

made of stainless steel 316 Ti

with lateral hole

- **MW 100x100x60/G1/B/Ex**
for G1 stuffing gland or
screw-in nipple
(fixing of the stuffing gland
or screw-in nipple via G1
counter nut)

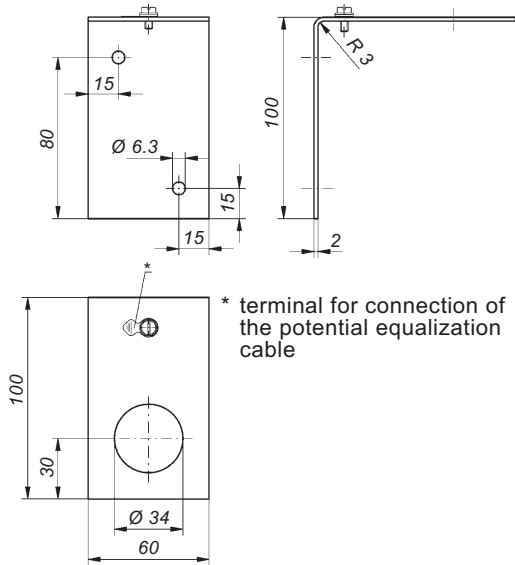

Mounting bracket

made of stainless steel 316 Ti

with 4 cable entries made of nickel-plated brass (on request
made of stainless steel) suitable for 4 floating switches

- **MW 190x430x40/4xM16-Ms/Ex**

